

IG5846

IGB4010-CPKG/V4A/US-104-DPA RT

Inductive sensors

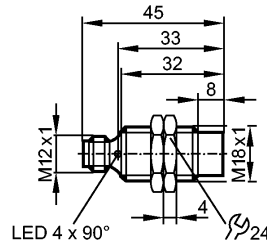

Product characteristics

Inductive sensor
Metal thread M18 x 1
Quick disconnect
gold-plated contacts
Sensing range 10 mm; [nf] non-flush mountable

Electrical data

Electrical design	DC PNP
Operating voltage [V]	10...36 DC
Current consumption [mA]	15 (24 V)
Protection class	II
Reverse polarity protection	yes

Outputs

Output function	complementary
Voltage drop [V]	< 2.5
Leakage current [mA]	< 0.5
Current rating [mA]	250
Short-circuit protection	yes (non-latching)
Overload protection	yes
Switching frequency [Hz]	300

Monitoring range

Sensing range [mm]	10
Real sensing range (Sr) [mm]	10 ± 10 %
Operating distance [mm]	0...8.1

Accuracy / deviations

Correction factors	mild steel = 1 / stainless steel approx. 0.7 / brass approx. 0.4 / aluminium approx. 0.3 / copper approx. 0.2
Hysteresis [% of Sr]	3...15
Switch-point drift [% of Sr]	-10...10

Environment

Ambient temperature [°C]	-25...80
Protection	IP 67

Tests / approvals

EMC	EN 61000-4-2 ESD: 4 kV CD / 8 kV AD
	EN 61000-4-3 HF radiated: 3 V/m
	EN 61000-4-4 Burst: 2 kV
	EN 61000-4-5 Surge: 0.5 kV (line to line, Ri: 20hm)
	EN 61000-4-6 HF conducted: 3 V

IG5846

IGB4010-CPKG/V4A/US-104-DPA RT

Inductive sensors

	EN 55011 (Emission):	class B
MTTF	[Years]	1447

Mechanical data		
Mounting		non-flush mountable
Housing materials		stainless steel 316Ti / 1.4571; active face: PBT (Pocan)
Weight	[kg]	0.043

Displays / operating elements		
Output status indication	LED	red (4 x 90°)

Electrical connection		
Connection		M12 connector; gold-plated contacts

Wiring

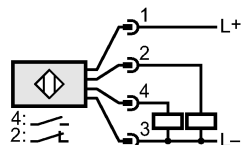

Accessories		
Accessories (included)		2 lock nuts

Remarks		
Pack quantity	[piece]	1