

SKKT 213, SKKH 213



SEMIPACK[®] 3

Thyristor / Diode Modules

SKKH 213

SKKT 213

Features

- Heat transfer through aluminium nitride ceramic isolated metal baseplate
- Chip soldered on direct copper bonded Al₂O₃ ceramic
- Thyristor with amplifying gate
- UL recognized, file no. E 63 532

Typical Applications

- DC motor control (e. g. for machine tools)
- AC motor starters
- Temperature control (e. g. for ovens, chemical processes)
- Professional light dimming (studios, theaters)

- 1) See the assembly instructions
- 2) The screws must be lubricated
- 3) $V_{isol} 1 \text{ s} / 1 \text{ min} = 4800 / 4000 \text{ V}$

V_{RSM} V	V_{RRM}, V_{DRM} V	$I_{TRMS} = 370 \text{ A}$ (maximum value for continuous operation) $I_{TAV} = 213 \text{ A}$ (sin. 180; $T_c = 90 \text{ }^\circ\text{C}$)		
900	800	SKKT 213/08D		
1300	1200	SKKT 213/12E	SKKH 213/12E	
1500	1400	SKKT 213/14E	SKKH 213/14E	
1700	1600	SKKT 213/16E	SKKH 213/16E	
1900	1800	SKKT 213/18E	SKKH 213/18E	

Symbol	Conditions	Values	Units
I_{TAV}	sin. 180; $T_c = 85 (100) \text{ }^\circ\text{C}$	230 (173)	A
I_D	P16/200F; $T_a = 35 \text{ }^\circ\text{C}$; B2 / B6	354 / 456	A
I_{RMS}	P16/200F; $T_a = 35 \text{ }^\circ\text{C}$; W1 / W3	425 / 3 * 360	A
I_{TSM}	$T_{vj} = 25 \text{ }^\circ\text{C}$; 10 ms	8500	A
	$T_{vj} = 130 \text{ }^\circ\text{C}$; 10 ms	7500	A
i^2t	$T_{vj} = 25 \text{ }^\circ\text{C}$; 8,3 ... 10 ms	361000	A ² s
	$T_{vj} = 130 \text{ }^\circ\text{C}$; 8,3 ... 10 ms	281000	A ² s
V_T	$T_{vj} = 25 \text{ }^\circ\text{C}$; $I_T = 750 \text{ A}$	max. 1,9	V
$V_{T(TO)}$	$T_{vj} = 130 \text{ }^\circ\text{C}$	0,95	V
r_T	$T_{vj} = 130 \text{ }^\circ\text{C}$	1,3	m Ω
I_{DD}, I_{RD}	$T_{vj} = 130 \text{ }^\circ\text{C}$; $V_{RD} = V_{RRM}$; $V_{DD} = V_{DRM}$	max. 50	mA
t_{gd}	$T_{vj} = 25 \text{ }^\circ\text{C}$; $I_G = 1 \text{ A}$; $di_G/dt = 1 \text{ A}/\mu\text{s}$	1	μs
t_{gr}	$V_D = 0,67 * V_{DRM}$	2	μs
$(di/dt)_{cr}$	$T_{vj} = 130 \text{ }^\circ\text{C}$	max. 250	A/ μs
$(dv/dt)_{cr}$	$T_{vj} = 130 \text{ }^\circ\text{C}$; SKK ...D / SKK ...E	max. 500 / 1000	V/ μs
t_q	$T_{vj} = 130 \text{ }^\circ\text{C}$	50 ... 150	μs
I_H	$T_{vj} = 25 \text{ }^\circ\text{C}$; typ. / max.	150 / 500	mA
I_L	$T_{vj} = 25 \text{ }^\circ\text{C}$ $R_G = 33 \Omega$; typ. / max.	300 / 2000	mA
V_{GT}	$T_{vj} = 25 \text{ }^\circ\text{C}$; d.c.	min. 3	V
I_{GT}	$T_{vj} = 25 \text{ }^\circ\text{C}$; d.c.	min. 200	mA
V_{GD}	$T_{vj} = 130 \text{ }^\circ\text{C}$; d.c.	max. 0,25	V
I_{GD}	$T_{vj} = 130 \text{ }^\circ\text{C}$; d.c.	max. 10	mA
$R_{th(j-c)}$	cont.; per thyristor / per module	0,11 / 0,055	K/W
$R_{th(j-c)}$	sin. 180; per thyristor / per module	0,115 / 0,057	K/W
$R_{th(j-c)}$	rec. 120; per thyristor / per module	0,125 / 0,0625	K/W
$R_{th(c-s)}$	per thyristor / per module	0,08 / 0,04	K/W
T_{vj}		- 40 ... + 130	$^\circ\text{C}$
T_{stg}		- 40 ... + 130	$^\circ\text{C}$
V_{isol}	a. c. 50 Hz; r.m.s.; 1 s / 1 min.	3600 / 3000	V~
M_s	to heatsink	$5 \pm 15 \text{ } \%$ ¹⁾	Nm
M_t	to terminals	$9 \pm 15 \text{ } \%$ ²⁾	Nm
a		$5 * 9,81$	m/s ²
m	approx.	400	g
Case	SKKT	A 43	
	SKKH	A 56	

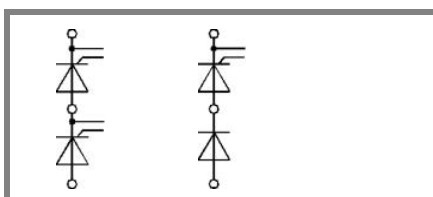

SKKT

SKKH

SKKT 213, SKKH 213

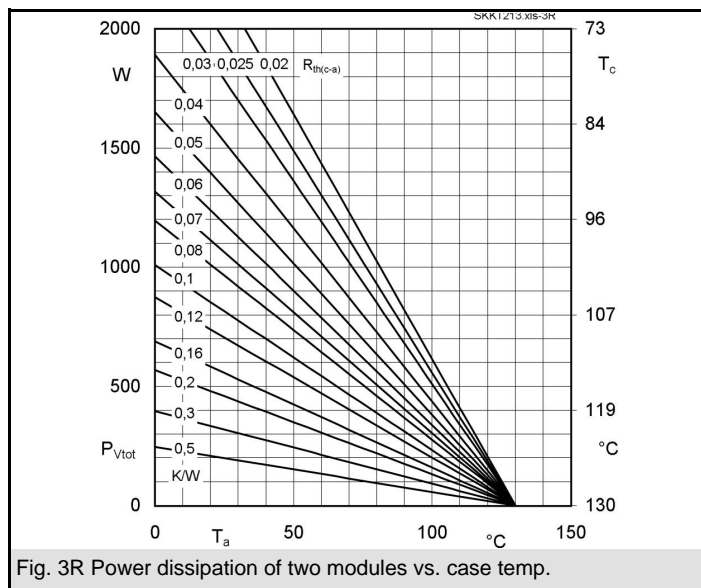
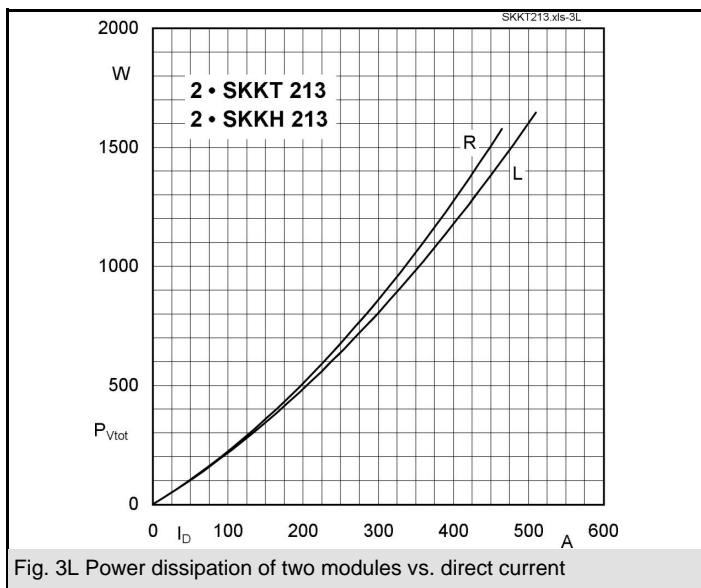
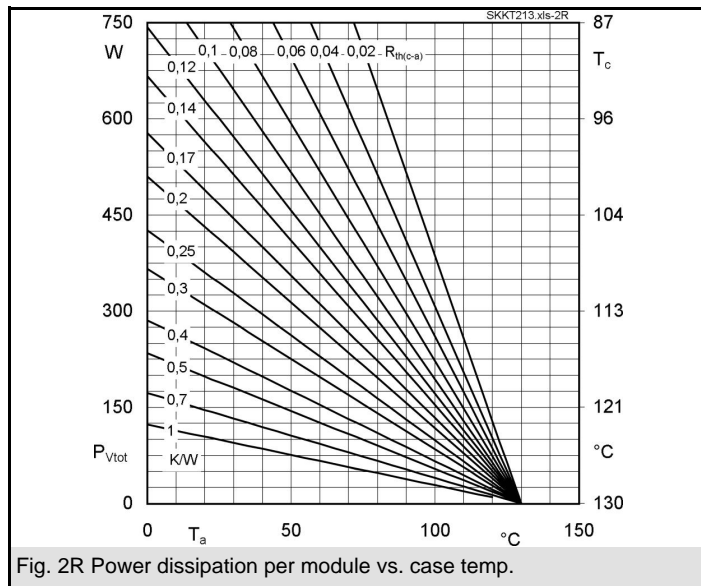
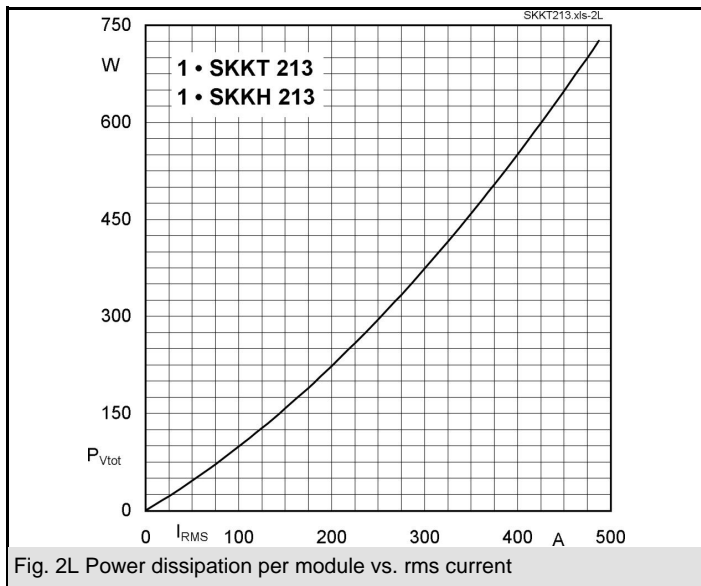
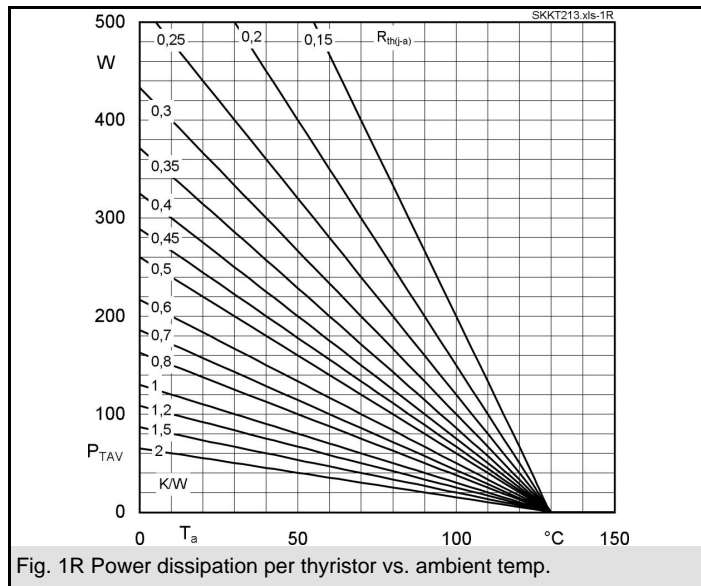
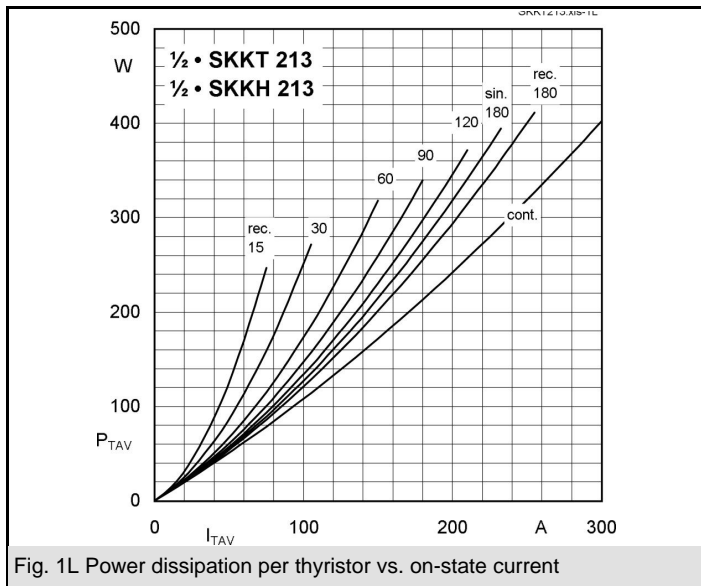

SKKT 213, SKKH 213

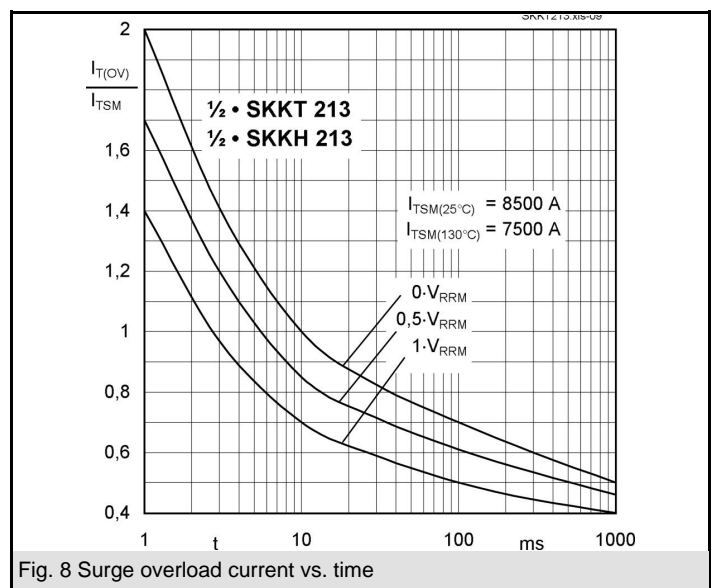
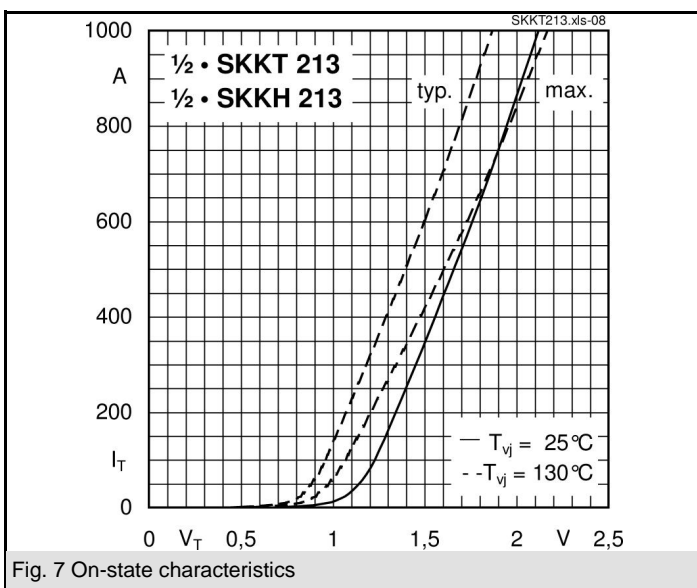
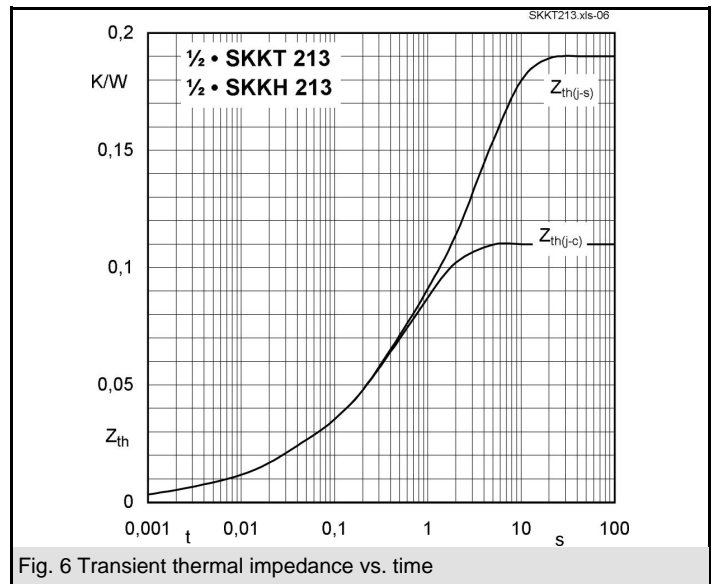
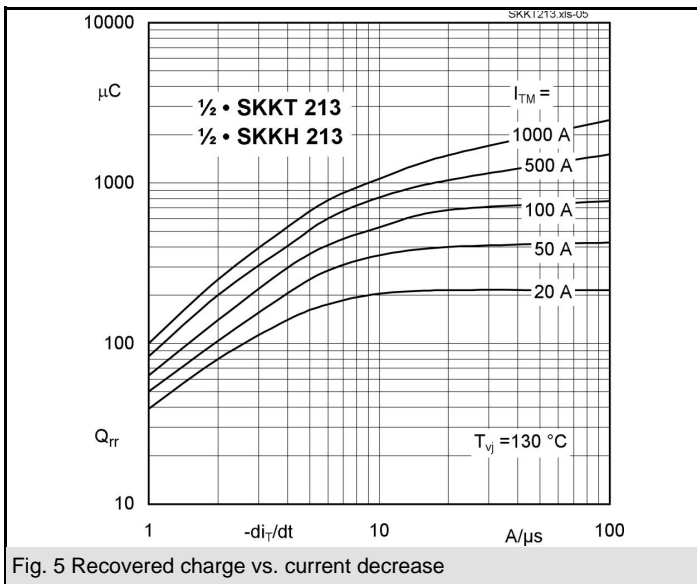
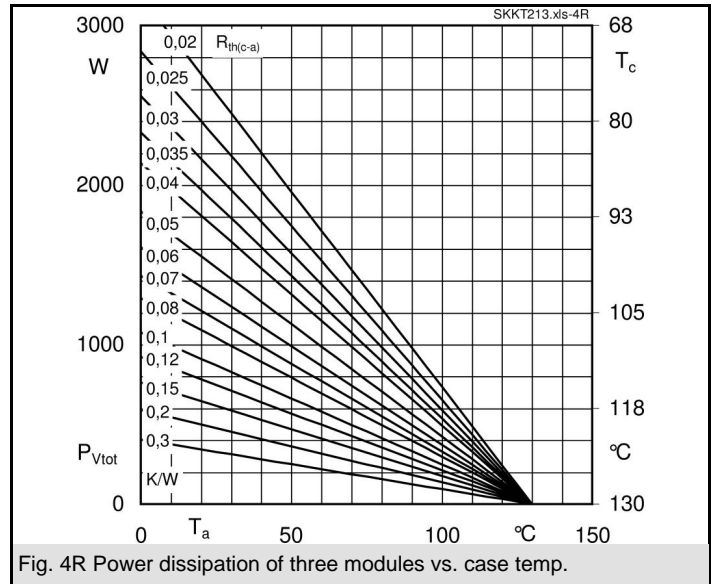
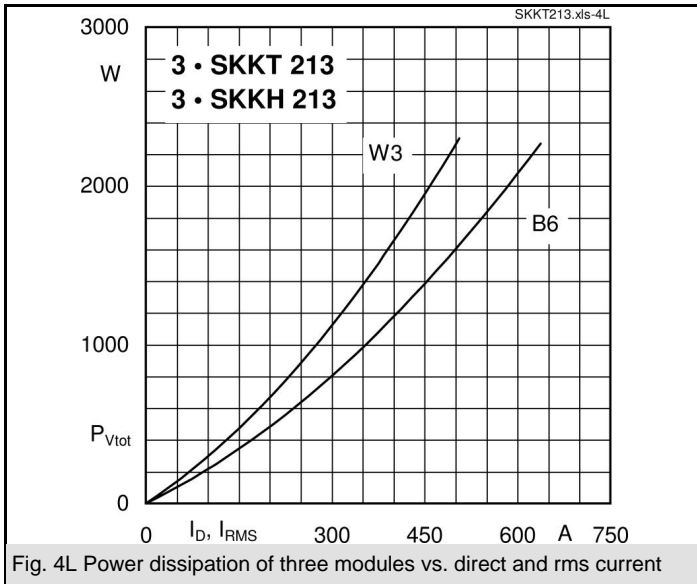

SKKT 213, SKKH 213

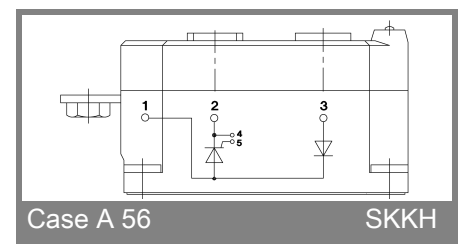
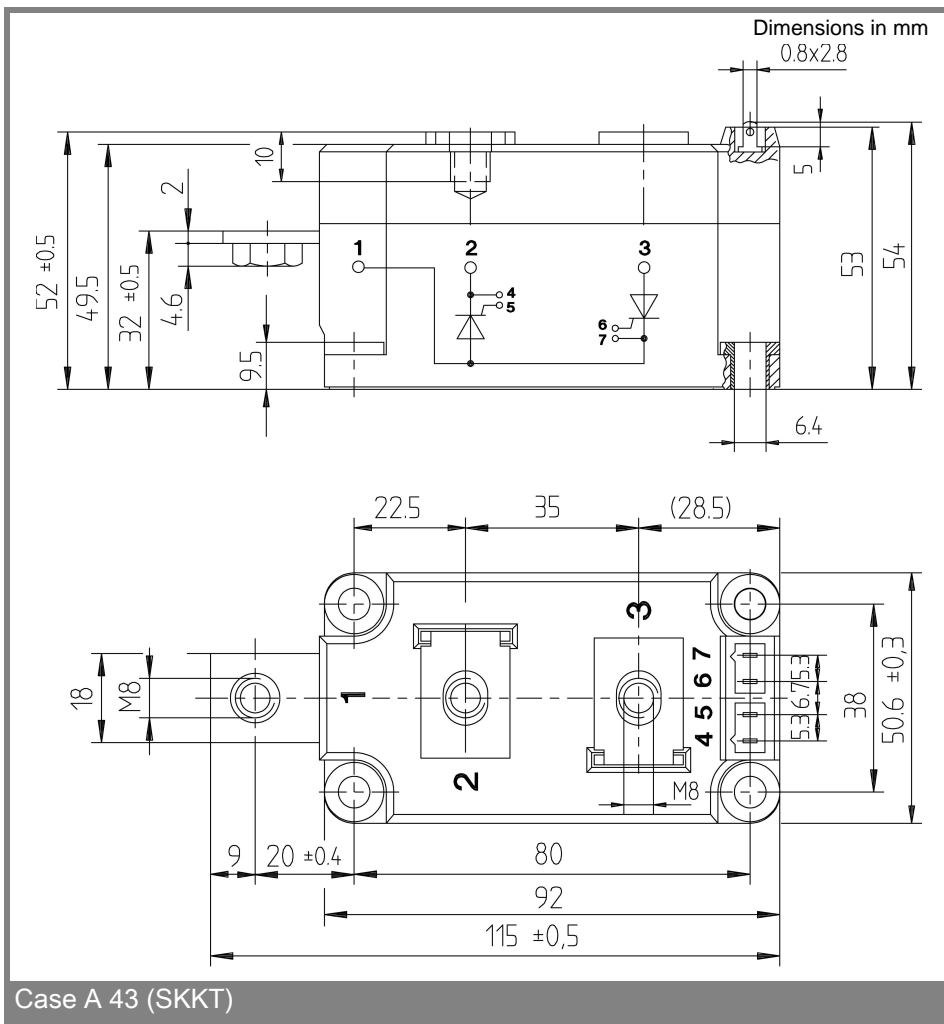
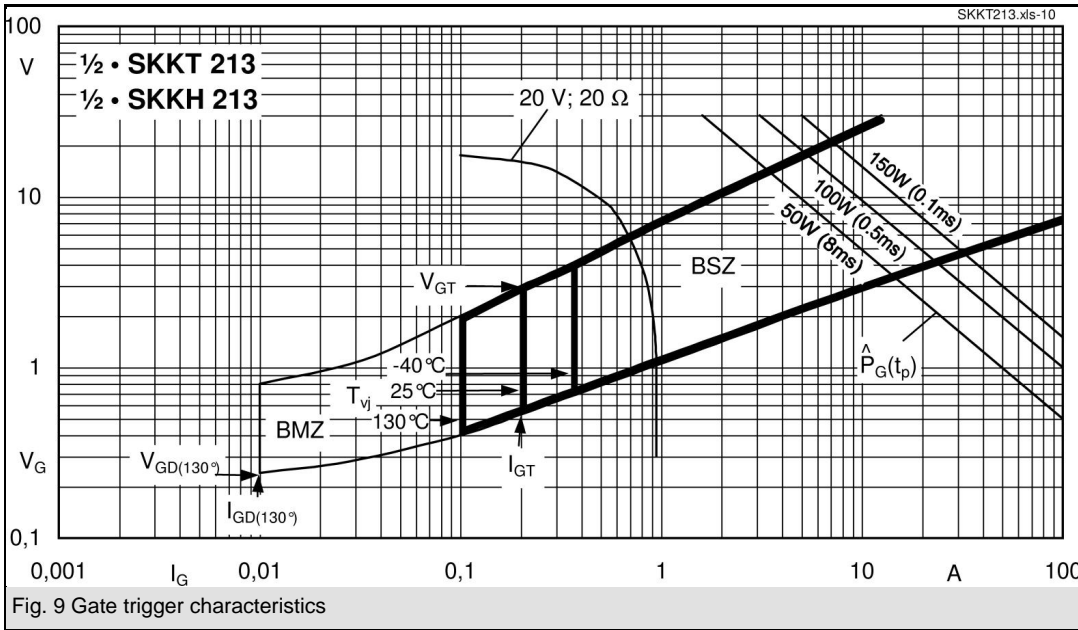

This technical information specifies semiconductor devices but promises no characteristics. No warranty or guarantee expressed or implied is made regarding delivery, performance or suitability.